

Flipper Assembly, Lower 500-5693-01 (Right), 500-5693-02 (Left)

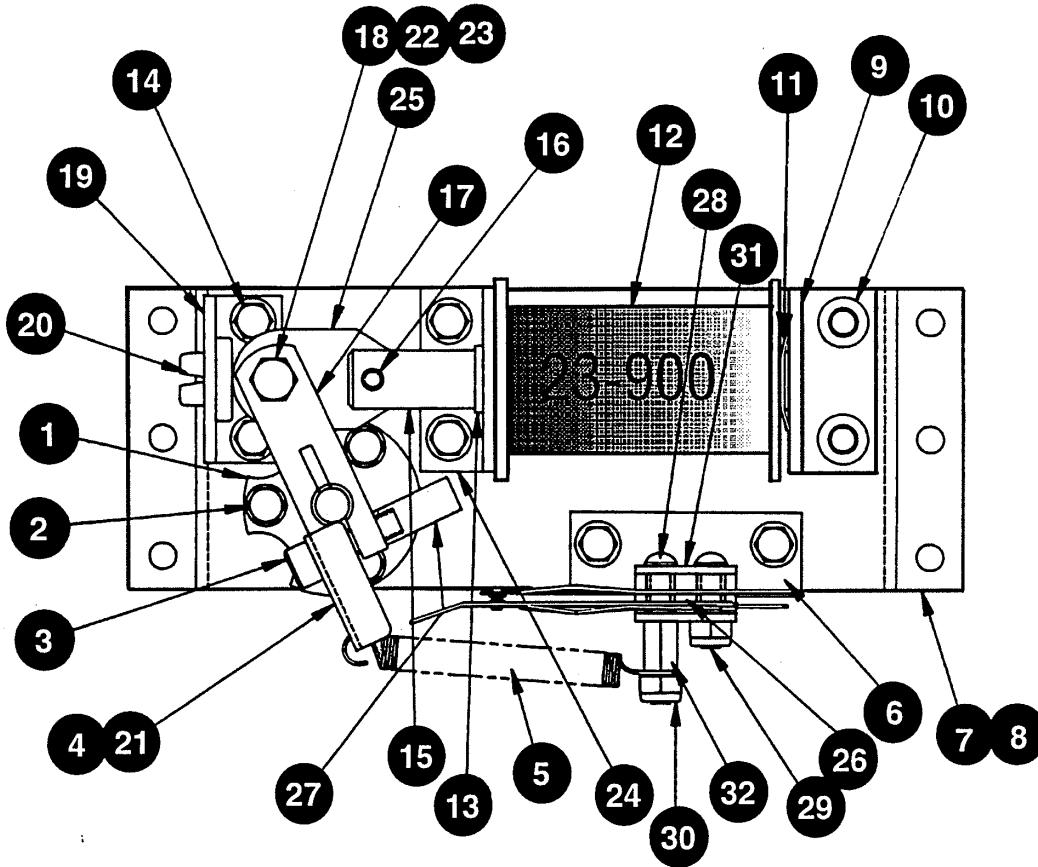

Item	Description	Part No.	Item	Description	Part No.
1	Flipper Bushing	545-5070-00	17	Pawl	530-5070-00
2	#6-32 X .38 LG HWH (Qty. 3)	237-5910-00	18	#10-32 X .75 LG Shoulder Bolt	231-5019-00
3	#10-32 SOC HD X .75 LG	237-5864-00	19	Plunger Stop Bracket	535-5279-01
4	Spring Bracket (Left)	535-6663-02	20	Nylon Stop	545-5445-00
5	Flipper Return Spring	265-5029-02	21	Spring Bracket (Right)	535-6663-01
6	Switch Mounting Bracket	535-6664-00	22	Bushing	530-5139-00
7	Flipper Base (Left)	515-5077-02	23	#10-32 Elastic Stop Nut	240-5203-00
8	Flipper Base (Right)	515-5077-01	24	Front Bracket	535-6453-00
9	Coil Stop Bracket	515-5346-00	25	Flipper Link	545-5401-00
10	¼-20 SOC HD X .38 LG (Qty. 2)	237-5861-00	26	Power Switch	180-5124-01
11	Spring Washer	269-5002-00	27	Plastic Cap	545-5084-00
12	Coil 23-900, incl. Coil Sleeve	090-5020-30	28	#6-32 X 1" LG PPH	237-5506-00
13	Coil Sleeve	545-5388-00	29	#6-32 X .63 LG PPH	237-5899-00
14	#8-32 X .38 LG HWH (Qty. 6)	237-5903-00	30	#6-32 Elastic Stop Nut	240-5005-00
15	Plunger and Link Assembly	515-5822-00	31	Switch Plate	535-5045-00
16	Roll Pin	251-5000-00	32	¼ Hex Spacer (¾" Long)	254-5008-12